

Mark For: _____
 Date: _____
 Dealer Acct #: _____
 Dealer: _____
 Dealer Contact: _____
 Dealer Address: _____
 Dealer City: _____ PV: _____ PC: _____
 Dealer Phone: () _____ Fax: () _____
 Confirmation Email: _____
 Confirm Via: Fax Email

Submitting for: Quote Order
 PO#: _____
ADDITIONAL SHIPPING INFORMATION
 Ship To: _____
 Attention: _____
 Address: _____
 Address: _____
 Ship To City: _____ PV: _____ PC: _____
 Ship To Phone: () _____ Fax: () _____

Hand and Arm Supports

Available on Dual Post and Dual Post Height Adjustable. Requires 3/4" round tubing for mounting the hardware.

Arm Trough with Fixed Hardware

✓	Option #	Definition	Price
<input type="checkbox"/>	JARM14F	Arm Trough 14" w/Fx Mnt Hdw	\$358.00
<input type="checkbox"/>	JARM18F	Arm Trough 18" w/ Fx Mnt Hdw	\$358.00
<input type="checkbox"/>	JARM22F	Arm Trough 22" w/ Fx Mnt Hdw	\$358.00

Arm Trough with Swing Away Hardware

<input type="checkbox"/>	JARM14SA	Arm Trough 14" L w/ SA Hdw	\$576.00
	JARM14	Arm Trough 14" Long	\$202.00
	SAARMHDW	Swing Away Hardware	\$374.00
<input type="checkbox"/>	JARM18SA	Arm Trough 18" L w/ SA Hdw	\$576.00
	JARM18	Arm Trough 18" Long	\$202.00
	SAARMHDW	Swing Away Hardware	\$374.00
<input type="checkbox"/>	JARM22SA	Arm Trough 22" L w/ SA Hdw	\$576.00
	JARM22	Arm Trough 22" Long	\$202.00
	SAARMHDW	Swing Away Hardware	\$374.00



Hardware		
A	Fixed	Swing-Away
14"	JARM14F	JARM14SA
18"	JARM18F	JARM18SA
22"	JARM22F	JARM22SA

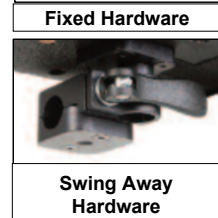
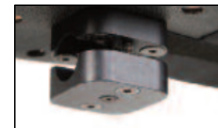

JAY Wrist Straps

<input type="checkbox"/>	ATS7510	Wrist Straps - Small	\$110.00
<input type="checkbox"/>	ATS7520	Wrist Straps - Medium	\$110.00
<input type="checkbox"/>	ATS7530	Wrist Straps - Large	\$110.00
<input type="checkbox"/>	ATS7590	Wrist Straps - Made To Order	\$123.00



Wrist Circumference		
S	ATS7510	5.5" - 7"
M	ATS7520	7.5" - 9"
L	ATS7530	9.5" - 11"
MTO	ATS7590	Specify

JAY Armrest Gel Pad Covers

<input type="checkbox"/>	131066	Gel Pad Cover - Desk Length	\$67.00
<input type="checkbox"/>	131067	Gel Pad Cover - Full Length	\$83.00
<input type="checkbox"/>	131071	Gel Pad Cover - Recline Right	\$112.00
<input type="checkbox"/>	131072	Gel Pad Cover - Recline Left	\$112.00



Armrest Gel Pad Cover

JAY YOUR WAY MODIFICATIONS

*Note: To order sizes offered via JAY Your Way add a "M" to the front of the part number and follow the prompts.
Please refer to the "JAY YOUR WAY" product catalog for complete listing of modifications*

JAY Arm Trough Modifications

<input type="checkbox"/>	Add Pommel to Hand Pad	\$40.00	<input type="checkbox"/>	Reduce height of side walls	NC
<input type="checkbox"/>	Foam overlay - add visco foam	\$40.00	<input type="checkbox"/>	Reduce Height by 1/2"	<input type="checkbox"/> Reduce Height by 1"
<input type="checkbox"/>	Add additional padded strap	\$25.00	<input type="checkbox"/>	Remove side walls	NC

JAY Arm Trough Colored Side Band Options

<input type="checkbox"/>	Cover Options						NC
<input type="checkbox"/>	Electric Lime	<input type="checkbox"/> Grey	<input type="checkbox"/> Hunter Orange	<input type="checkbox"/> Navy Blue	<input type="checkbox"/> Pink Sorbet	<input type="checkbox"/> Shocking Pink	<input type="checkbox"/> Turquoise
<input type="checkbox"/>	University Red	<input type="checkbox"/> Very Violet	<input type="checkbox"/> Volt Yellow	<input type="checkbox"/> Digital Camo			

JAY Arm Trough Contact Surface Options

<input type="checkbox"/>	Micro Climatic Contact Surface	NC	<input type="checkbox"/>	Naughahyde	NC
<input type="checkbox"/>	Sheep Skin	NC			

Lower Extremity Support

JAY Lower Extremity Support

<input type="checkbox"/>	161565	Large Pad 10"L x 8"W - Right	\$6JJ.00
<input type="checkbox"/>	161566	Large Pad 10"L x 8"W - Left	\$6JJ.00
<input type="checkbox"/>	161567	Std Pad 8"L x 6"W - Right	\$6JJ.00
<input type="checkbox"/>	161568	Std Pad 8"L x 6"W - Left	\$6JJ.00



Knee Adductors

JAY Knee Adductors with Pads

<input type="checkbox"/>	KAK21XXL	Knee Adductor Short w/ Pad - L	\$51 €00
		<input type="checkbox"/> 3" Pad <input type="checkbox"/> 4" Pad	
<input type="checkbox"/>	KAK21XXR	Knee Adductor Short w/ Pad - R	\$51 €00
		<input type="checkbox"/> 3" Pad <input type="checkbox"/> 4" Pad	
<input type="checkbox"/>	KAK31XXL	Knee Adductor Long w/ Pad - L	\$51 €00
		<input type="checkbox"/> 3" Pad <input type="checkbox"/> 4" Pad	
<input type="checkbox"/>	KAK31XXR	Knee Adductor Long w/ Pad - R	\$51 €00
		<input type="checkbox"/> 3" Pad <input type="checkbox"/> 4" Pad	

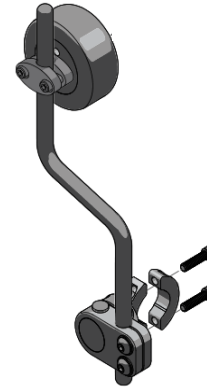

JAY Knee Adductors without Pads

<input type="checkbox"/>	HDW4853	Knee Adductor Short - Left	\$4H .00
<input type="checkbox"/>	HDW4854	Knee Adductor Short - Right	\$4H .00
<input type="checkbox"/>	HDW4851	Knee Adductor Long - Left	\$4H .00
<input type="checkbox"/>	HDW4852	Knee Adductor Long - Right	\$4H .00

JAY Knee Adductors Pads Only

<input type="checkbox"/>	KAD10XX	3" Round Pad	\$51 .00
<input type="checkbox"/>	KAD11XX	4" Round Pad	\$51 .00
<input type="checkbox"/>	KAD19XX	Made To Order Pad	\$74.00

Foot Positioning

Calculating Foot Box Width	
Flared Frame	Foot Box Width = Seat Width + 2"
Offset Hanger	Foot Box Width = Seat Width + 2"
0' Offset	Foot Box Width = Seat Width
1' Offset	Foot Box Width = Seat Width - 2"
2' Offset	Foot Box Width = Seat Width - 4"

Single Foot Box

<input type="checkbox"/>	JFOOTSS	Footbox Single Std Ht	\$372.00
<input type="checkbox"/>	JFOOTST	Footbox Single Tall Ht	\$372.00



Single Foot Box

	Height	A	B
JFOOTSS	Standard	8"	7.5"
JFOOTST	Tall	12"	7.5"

Full Foot Box

<input type="checkbox"/>	JFOOT12S	Full Foot Box 12"W Std Ht.	\$507.00
<input type="checkbox"/>	JFOOT14S	Full Foot Box 14"W Std Ht.	\$507.00
<input type="checkbox"/>	JFOOT16S	Full Foot Box 16"W Std Ht.	\$507.00
<input type="checkbox"/>	JFOOT18S	Full Foot Box 18"W Std Ht.	\$507.00
<input type="checkbox"/>	JFOOT20S	Full Foot Box 20"W Std Ht.	\$534.00
<input type="checkbox"/>	JFOOT22S	Full Foot Box 22"W Std Ht.	\$534.00
<input type="checkbox"/>	JFOOT16T	Full Foot Box 16"W Tall Ht.	\$573.00
<input type="checkbox"/>	JFOOT18T	Full Foot Box 18"W Tall Ht.	\$573.00
<input type="checkbox"/>	JFOOT20T	Full Foot Box 20"W Tall Ht.	\$659.00
<input type="checkbox"/>	JFOOT22T	Full Foot Box 22"W Tall Ht.	\$659.00

Full Foot Box

	Height	Width	A	B
JFOOT12S	Standard	12"	8"	9.5"
JFOOT14S	Standard	14"	8"	11.5"
JFOOT16S	Standard	16"	8"	13.5"
JFOOT18S	Standard	18"	8"	15.5"
JFOOT20S	Standard	20"	8"	17.5"
JFOOT22S	Standard	22"	8"	19.5"
JFOOT16T	Tall	16"	12"	13.5"
JFOOT18T	Tall	18"	12"	15.5"
JFOOT20T	Tall	20"	12"	17.5"
JFOOT22T	Tall	22"	12"	19.5"



Foot Positioning (Continued)

Full Foot Box with Divider

<input type="checkbox"/>	JFOOT16SD	Full Footbox 16"W Std Ht. w/ Div.	\$520.00
<input type="checkbox"/>	JFOOT18SD	Full Footbox 18"W Std Ht. w/ Div.	\$520.00
<input type="checkbox"/>	JFOOT20SD	Full Footbox 20"W Std Ht. w/ Div.	\$675.00
<input type="checkbox"/>	JFOOT22SD	Full Footbox 22"W Std Ht. w/ Div.	\$675.00
<input type="checkbox"/>	JFOOT16TD	Full Footbox 16"W Tall Ht. w/ Div.	\$587.00
<input type="checkbox"/>	JFOOT18TD	Full Footbox 18"W Tall Ht. w/ Div.	\$587.00
<input type="checkbox"/>	JFOOT20TD	Full Footbox 20"W Tall Ht. w/ Div.	\$675.00
<input type="checkbox"/>	JFOOT22TD	Full Footbox 22"W Tall Ht. w/ Div.	\$675.00

Full Foot Box with Divider

	Height	Width	A	B
JFOOT16SD	Standard	16"	8"	13.5"
JFOOT18SD	Standard	18"	8"	15.5"
JFOOT20SD	Standard	20"	8"	17.5"
JFOOT22SD	Standard	22"	8"	19.5"
JFOOT16TD	Standard	16"	12"	13.5"
JFOOT18TD	Standard	18"	12"	15.5"
JFOOT20TD	Tall	20"	12"	17.5"
JFOOT22TD	Tall	22"	12"	19.5"



JAY Ankle Positioning System

<input type="checkbox"/>	TST6501L	Ankle Positioning X-Small - L	\$120.00
<input type="checkbox"/>	TST6501R	Ankle Positioning X-Small - R	\$120.00
<input type="checkbox"/>	TST6511L	Ankle Positioning Small - Left	\$120.00
<input type="checkbox"/>	TST6511R	Ankle Positioning Small - Right	\$120.00
<input type="checkbox"/>	TST6521L	Ankle Positioning Medium - L	\$120.00
<input type="checkbox"/>	TST6521R	Ankle Positioning Medium - R	\$120.00
<input type="checkbox"/>	TST6541L	Ankle Positioning Large - Left	\$120.00
<input type="checkbox"/>	TST6541R	Ankle Positioning Large - Right	\$120.00
<input type="checkbox"/>	TST6561L	Ankle Positioning X-Large - L	\$120.00
<input type="checkbox"/>	TST6561R	Ankle Positioning X-Large - R	\$120.00
<input type="checkbox"/>	TST6591L	Ankle Positioning Made To Order - L	\$134.00
<input type="checkbox"/>	TST6591R	Ankle Positioning Made To Order - R	\$134.00



Ankle Positioning System

JAY Foot & Ankle Positioning System

<input type="checkbox"/>	TST6510L	Foot & Ankle Pos Small - Left	\$153.00
<input type="checkbox"/>	TST6510R	Foot & Ankle Pos Small - Right	\$153.00
<input type="checkbox"/>	TST6520L	Foot & Ankle Pos Medium - L	\$153.00
<input type="checkbox"/>	TST6520R	Foot & Ankle Pos Medium - R	\$153.00
<input type="checkbox"/>	TST6540L	Foot & Ankle Pos Large - Left	\$153.00
<input type="checkbox"/>	TST6540R	Foot & Ankle Pos Large - Right	\$153.00
<input type="checkbox"/>	TST6560L	Foot & Ankle Pos X-Large - L	\$153.00
<input type="checkbox"/>	TST6560R	Foot & Ankle Pos X-Large - R	\$153.00



Foot & Ankle Positioning

JAY Padded Ankle / Toe Strap Only

<input type="checkbox"/>	TST4000	Padded Ankle/Toe Strap - S	\$38.00
<input type="checkbox"/>	TST4200	Padded Ankle/Toe Strap - M	\$38.00
<input type="checkbox"/>	TST4500	Padded Ankle/Toe Strap - L	\$38.00



Padded Ankle Toe Strap Only

JAY Flexi-Feet System

<input type="checkbox"/>	32600XS-RT	Flexi-Feet System - X-Small	\$247.00
<input type="checkbox"/>	32600S-RT	Flexi-Feet System - Small	\$247.00
<input type="checkbox"/>	32600M-RT	Flexi-Feet System - Medium	\$247.00
<input type="checkbox"/>	32600L-RT	Flexi-Feet System - Large	\$247.00

Flexi-Feet

	Item#	A	B
XS	32600XS-RT	4.5"	2.75"
S	32600S-RT	6.25"	3"
M	32600M-RT	8.25"	3.5"
L	32600LS-RT	9"	4.5"



JAY Shoe Holders

<input type="checkbox"/>	TST6000	Shoe Holder - Small	\$110.00
<input type="checkbox"/>	TST6100	Shoe Holder - Medium	\$110.00
<input type="checkbox"/>	TST6200	Shoe Holder - Large	\$110.00
<input type="checkbox"/>	TST6300	Shoe Holder - X-Large	\$110.00



Shoe Holder



Shoe Holder with Padded Straps

JAY Shoe Holder with Padded Strap

<input type="checkbox"/>	TST6001	Shoe Holder w/ Pad Strap - S	\$120.00
<input type="checkbox"/>	TST6101	Shoe Holder w/ Pad Strap - M	\$120.00
<input type="checkbox"/>	TST6201	Shoe Holder w/ Pad Strap - L	\$120.00
<input type="checkbox"/>	TST6301	Shoe Holder w/ Pad Strap - XL	\$120.00

Foot Positioning (Continued)

JAY Shoe Holder with Tendon Relief

<input type="checkbox"/>	TST6061	Shoe Holder w/ Tendon Relief - S	\$112.00
<input type="checkbox"/>	TST6161	Shoe Holder w/ Tendon Relief - M	\$112.00
<input type="checkbox"/>	TST6261	Shoe Holder w/ Tendon Relief - L	\$112.00
<input type="checkbox"/>	TST6361	Shoe Holder w/ Tendon Relief - XL	\$112.00



Shoe Holder with Tendon Relief

JAY Padded Calf Panel

<input type="checkbox"/>	PLS3010	Padded Calf Panel - Small	\$149.00
<input type="checkbox"/>	PLS3020	Padded Calf Panel - Medium	\$149.00
<input type="checkbox"/>	PLS3030	Padded Calf Panel - Large	\$149.00
<input type="checkbox"/>	PLS3099	Padded Calf Panel - Made To Order	\$247.00

Padded Calf Panel

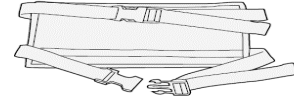

JAY YOUR WAY MODIFICATIONS

*Note: To order sizes offered via JAY Your Way add a "M" to the front of the part number and follow the prompts.
Please refer to the "JAY YOUR WAY" product catalog for complete listing of modifications*

JAY Foot Boxes Modifications

<input type="checkbox"/>	Add Leg Strap	\$25.00	<input type="checkbox"/>	Reduce Leg Through Size	NC
<input type="checkbox"/>	Foam overlay - add visco foam	\$40.00	<input type="checkbox"/>	Reduce Opening by 1/2"	<input type="checkbox"/>
			<input type="checkbox"/>	Reduce Opening by 1"	
			<input type="checkbox"/>	Increase Leg Through Size	NC
			<input type="checkbox"/>	Increase Opening by 1/2"	<input type="checkbox"/>
			<input type="checkbox"/>	Increase Opening by 1"	

JAY Foot Boxes Colored Side Band Options

<input type="checkbox"/>	Cover Options	NC
<input type="checkbox"/>	Electric Lime	<input type="checkbox"/>
<input type="checkbox"/>	Grey	<input type="checkbox"/>
<input type="checkbox"/>	Hunter Orange	<input type="checkbox"/>
<input type="checkbox"/>	Navy Blue	<input type="checkbox"/>
<input type="checkbox"/>	Pink Sorbet	<input type="checkbox"/>
<input type="checkbox"/>	Shocking Pink	<input type="checkbox"/>
<input type="checkbox"/>	Turquoise	<input type="checkbox"/>
<input type="checkbox"/>	University Red	<input type="checkbox"/>
<input type="checkbox"/>	Very Violet	<input type="checkbox"/>
<input type="checkbox"/>	Volt Yellow	<input type="checkbox"/>
<input type="checkbox"/>	Digital Camo	<input type="checkbox"/>

JAY Foot Boxes Contact Surface Options

<input type="checkbox"/>	Micro Climatic Contact Surface	NC	<input type="checkbox"/>	Naugahyde	NC
<input type="checkbox"/>	Sheep Skin	NC			



Sunrise Medical Canada Inc.
237 Romina Drive, Unit 3 • Concord, ON L4K 4V3 • Canada