



**Zippie X'Cape**  
**July 2018**  
**EIFZ1**



Date: \_\_\_\_\_ **SUBMITTING FOR:**  Quote  Order

Dealer Acct #: \_\_\_\_\_

Dealer: \_\_\_\_\_

Dealer Contact: \_\_\_\_\_

Dealer Address: \_\_\_\_\_

Dealer City: \_\_\_\_\_ PV: \_\_\_\_\_ PC: \_\_\_\_\_

Dealer Phone: ( ) \_\_\_\_\_ Fax: ( ) \_\_\_\_\_

PO#: \_\_\_\_\_

Ship To: \_\_\_\_\_

Attention: \_\_\_\_\_

Address: \_\_\_\_\_

Address: \_\_\_\_\_

Ship To City: \_\_\_\_\_ PV: \_\_\_\_\_ PC: \_\_\_\_\_

Ship To Phone: ( ) \_\_\_\_\_ Fax: ( ) \_\_\_\_\_

Confirm Via:  Fax  Email

Mark For: \_\_\_\_\_

Option #	Definition	Price	Option #	Definition	Price
----------	------------	-------	----------	------------	-------

**1. FRAME**

A. Zippie X'CAPE - TRANSIT INCLUDED 165 lbs. Weight Capacity			B. Zippie X'CAPE - TRANSIT OPTIONAL 165 lbs. Weight Capacity				
A. FRAME STYLE (Includes True Fit) (N/A w/ Xtender)			B. FRAME STYLE (Includes True Fit)				
<input type="checkbox"/>	121WM87	X'CAPE - Transit Incl. without seating (Custom seating opts available)	\$3,224.00	<input type="checkbox"/>	121WM83	X'CAPE - Transit Opt. without seating (Custom seating opts available)	\$3,126.00
<input type="checkbox"/>	121WM84	X'CAPE - Transit Incl. w/ Seating (Sling and Back Uph.)	\$3,224.00	<input type="checkbox"/>	121WM85	X'CAPE - Transit Opt. w/ Seating (Sling and Back Uph.)	\$3,126.00

**TRANSIT SYSTEM WC-19**

<input type="checkbox"/>	121TO48	Transit Opt. (N/A w/ Xtender)	NC	<input type="checkbox"/>	121TO40	Omit Transit	NC
--------------------------	---------	-------------------------------	----	--------------------------	---------	--------------	----

**FRAME TYPE**

<input type="checkbox"/>	121FT64	Zippie-Swing Away Frame	NC	<input type="checkbox"/>	121FT65	Zippie-80° Fixed Front Frame	NC
--------------------------	---------	-------------------------	----	--------------------------	---------	------------------------------	----

**2. SIZE/SEATING**

**2A. FRAME WIDTH**

8", 9" and 10" widths N/A with Xtender

<input type="checkbox"/>	121W48	8" (Frame Width Growth 9"-10")	NC	<input type="checkbox"/>	121W53	13" (Frame Width Growth 14"-15")	NC
<input type="checkbox"/>	121W49	9" (Frame Width Growth 10"-11")	NC	<input type="checkbox"/>	121W54	14" (Frame Width Growth 15"-16")	NC
<input type="checkbox"/>	121W50	10" (Frame Width Growth 11"-12")	NC	<input type="checkbox"/>	121W55	15" (Frame Width Growth 16"-17")	NC
<input type="checkbox"/>	121W51	11" (Frame Width Growth 12"-13")	NC	<input type="checkbox"/>	121W56	16" (Frame Width Growth 17"-18")	NC
<input type="checkbox"/>	121W52	12" (Frame Width Growth 13"-14")	NC				

**2B/C. SLING DEPTH, FRAME DEPTH AND BACK POST POSITION. See matrix on page 2.**

8"-11" Frame Depth with 20", 22" or 24" wheels and Custom Seating must have hublock or Fixed Front frame. When selecting Frame Depth with custom seating, add 1" to accommodate seating. Example: need 12" depth, order 13" depth.

**2B. Sling Depth when choosing with Seating Sling must be up to 3" less than or equal to the Frame Depth (C.)**

<input type="checkbox"/>	121GJ1	8"	NC	<input type="checkbox"/>	121GJ7	14"	NC
<input type="checkbox"/>	121GJ2	9"	NC	<input type="checkbox"/>	121GJ8	15"	NC
<input type="checkbox"/>	121GJ3	10"	NC	<input type="checkbox"/>	121GJ9	16"	NC
<input type="checkbox"/>	121GJ4	11"	NC	<input type="checkbox"/>	121GJ10	17"	NC
<input type="checkbox"/>	121GJ5	12"	NC	<input type="checkbox"/>	121GJ11	18"	NC
<input type="checkbox"/>	121GJ6	13"	NC				

**2C. Frame Depth and Back Post Position with Growth Note: Must be equal or greater than Sling Depth if chosen with seat Sling**

<input type="checkbox"/>	121FD40	8" (Frame depth growth 9"-11", N/A w/ 24" wheels)	NC	<input type="checkbox"/>	121FD46	14" (Frame depth growth 15"-17")	NC
<input type="checkbox"/>	121FD41	9" (Frame depth growth 10"-12", N/A w/ 24" wheels)	NC	<input type="checkbox"/>	121FD47	15" (Frame depth growth 16"-18")	NC
<input type="checkbox"/>	121FD42	10" (Frame depth growth 11"-13")	NC	<input type="checkbox"/>	121FD48	16" (Frame depth growth 17"-19")	NC
<input type="checkbox"/>	121FD43	11" (Frame depth growth 12"-14")	NC	<input type="checkbox"/>	121FD49	17" (Frame depth growth 18"-20")	NC
<input type="checkbox"/>	121FD44	12" (Frame depth growth 13"-15")	NC	<input type="checkbox"/>	121FD50	18" (Frame depth growth 19"-20")	NC
<input type="checkbox"/>	121FD45	13" (Frame depth growth 14"-16")	NC				

**SEATING**

Seat Sling			
<input type="checkbox"/>	121OP01	Standard Seat Sling	STD
<input type="checkbox"/>	121OP04	Omit Seat Sling (available when base is ordered with seating)	NC

Cushions			
Some limitations may exist on 2" Cushion and smaller widths			
<input type="checkbox"/>	121CU30	1" Foam Cushion	\$132.00
<input type="checkbox"/>	121CU31	2" Foam Cushion	\$132.00

JAY Cushions (Optional)			
To order any other JAY cushions on-chair, please see the JAY price list. Cushion name or part number must be filled out w/ desired width and depth			
<input type="checkbox"/>	121JC20	JAY Bundled Cushion Cushion Name or Part# Width (in.):                      Depth (in.):	Price List

Sling and 1" Cushion Matrix																
		Width													Sling Depth	
		8"	9"	10"	11"	12"	13"	14"	15"	16"						
Sling Depth	8"															8"
	9"															9"
	10"															10"
	11"															11"
	12"															12"
	13"															13"
	14"															14"
	15"															15"
	16"															16"
17"															17"	
18"															18"	
		Width														
		1" cushion available at these sizes														
		1" cushion N/A at these sizes														

Seat Sling to Frame Depth Matrix																		
Difference from front of frame to front of sling																		
		Sling Length																
		8"	9"	10"	11"	12"	13"	14"	15"	16"	17"	18"						
Frame Length	8"	0"																
	9"	0"	0"															
	10"	0"	0"	0"														
	11"	1"	1"	1"	0"													
	12"		2"	2"	1"	0"												
	13"			3"	2"	1"	0"											
	14"				3"	2"	1"	0"										
	15"					3"	2"	1"	0"									
	16"						2"	1"	0"	0"								
17"							1"	0"	0"	0"								
18"								0"	0"	0"	0"							

2" Cushion Matrix																
		Width													Sling Depth	
		8"	9"	10"	11"	12"	13"	14"	15"	16"						
Sling Depth	8"															8"
	9"															9"
	10"															10"
	11"															11"
	12"															12"
	13"															13"
	14"															14"
	15"															15"
	16"															16"
17"															17"	
18"															18"	
		Width														
		2" cushion available at these sizes														
		2" cushion N/A at these sizes														

**3. CASTERS/SEAT HEIGHT**

Caster Wheel			
<input type="checkbox"/>	121CW30	3" Micro Light Up	NC
<input type="checkbox"/>	121CW3	4" Low-Profile Polyurethane	NC
<input type="checkbox"/>	121CW31	4" Micro Light Up	\$101.00
<input type="checkbox"/>	121CW64	4" x 1-1/2" Aluminum Soft Roll	\$180.00
<input type="checkbox"/>	121CW5	5" Low-Profile Polyurethane	NC
<input type="checkbox"/>	121CW51	5" Micro Light Up	\$101.00
<input type="checkbox"/>	121CW6	5" Soft Roll (Grey)	\$101.00
<input type="checkbox"/>	121CW7	5"x1-1/2" Semi-Pneumatic	\$101.00
<input type="checkbox"/>	121CW66	5"x1-1/2" Aluminum Soft Roll	\$101.00
<input type="checkbox"/>	121CW34	6" Poly	NC
<input type="checkbox"/>	121CW35	6"x1-1/2" Semi-Pneumatic	\$101.00

Caster Forks			
<input type="checkbox"/>	121CF65	Multiple Position	NC

Front Seat Heights Matrix				
Rear Wheel Size	Front Caster			
	<input type="checkbox"/> 3"	<input type="checkbox"/> 4"	<input type="checkbox"/> 5"	<input type="checkbox"/> 6"
<input type="checkbox"/> 12" <input type="checkbox"/> 16" <input type="checkbox"/> 20" <input type="checkbox"/> 22"	<input type="checkbox"/> 13.0"	<input type="checkbox"/> 13.0"	<input type="checkbox"/> 14.0"	<input type="checkbox"/> 15.0"
	<input type="checkbox"/> 13.5"	<input type="checkbox"/> 13.5"	<input type="checkbox"/> 14.5"	<input type="checkbox"/> 15.5"
	<input type="checkbox"/> 14.0"	<input type="checkbox"/> 14.0"	<input type="checkbox"/> 15.0"	<input type="checkbox"/> 16.0"
	<input type="checkbox"/> 14.5"	<input type="checkbox"/> 14.5"	<input type="checkbox"/> 15.5"	<input type="checkbox"/> 16.5"
	<input type="checkbox"/> 15.0"	<input type="checkbox"/> 15.0"	<input type="checkbox"/> 16.0"	<input type="checkbox"/> 17.0"
	<input type="checkbox"/> 15.5"	<input type="checkbox"/> 15.5"	<input type="checkbox"/> 16.5"	<input type="checkbox"/> 17.5"
	<input type="checkbox"/> 16.0"	<input type="checkbox"/> 16.0"	<input type="checkbox"/> 17.0"	<input type="checkbox"/> 18.0"
	<input type="checkbox"/> 16.5"	<input type="checkbox"/> 16.5"	<input type="checkbox"/> 17.5"	
	<input type="checkbox"/> 17.0"	<input type="checkbox"/> 17.0"		
<input type="checkbox"/> 24"	N/A		<input type="checkbox"/> 14.0"	<input type="checkbox"/> 15.0"
			<input type="checkbox"/> 14.5"	<input type="checkbox"/> 15.5"
	<input type="checkbox"/> 14.0"	<input type="checkbox"/> 14.0"	<input type="checkbox"/> 15.0"	<input type="checkbox"/> 16.0"
	<input type="checkbox"/> 14.5"	<input type="checkbox"/> 14.5"	<input type="checkbox"/> 15.5"	<input type="checkbox"/> 16.5"
	<input type="checkbox"/> 15.0"	<input type="checkbox"/> 15.0"	<input type="checkbox"/> 16.0"	<input type="checkbox"/> 17.0"
	<input type="checkbox"/> 15.5"	<input type="checkbox"/> 15.5"	<input type="checkbox"/> 16.5"	<input type="checkbox"/> 17.5"
	<input type="checkbox"/> 16.5"	<input type="checkbox"/> 16.5"	<input type="checkbox"/> 17.0"	<input type="checkbox"/> 18.0"
	<input type="checkbox"/> 17.0"	<input type="checkbox"/> 17.0"	<input type="checkbox"/> 17.5"	
	N/A	<input type="checkbox"/> 17.5"		

Standard Frame
Hemi Fame (N/A w/ 90° hanger, 80° hanger footplate in lowest position may cause interference w/caster)
Depends on Caster setting

FRONT SEAT HEIGHTS ARE SHOWN IN THE BOXES IN THE FRONT SEAT HEIGHTS MATRIX. DEPENDING ON CG SETTING, SEAT DEPTH, AND FRAME SIZE SOME OF THE SIZES MAY NOT BE AVAILABLE

**4.REAR WHEELS/SEAT HEIGHT**

**XTENDER POWER ASSIST OPTION**

22" & 24" wheels only. RSH 14" to 16" for 22", RSH 15.0" to 17" for 24". 0° camber, pneumatic tire. Anti-Tips no charge. Dual drive mode available through B4Me.

**Xtender Power Assist**

<input type="checkbox"/>	121XT6	22" Xtender Power Assist JWX-2 NICKEL	\$9,225.00
<input type="checkbox"/>	121XT7	22" Xtender Power Assist JWX-2 LITHIUM	\$10,710.00
<input type="checkbox"/>	121XT4	24" Xtender Power Assist JWX-2 NICKEL	\$9,225.00
<input type="checkbox"/>	121XT5	24" Xtender Power Assist JWX-2 LITHIUM	\$10,710.00

Please select one of the following handrim options

<input type="checkbox"/>	121XH5	Plastic Coated	NC
<input type="checkbox"/>	121XH6	Stainless Steel	NC

**Xtender - Other Options**

<input type="checkbox"/>	121XA10	Spare NiMH Power Pack - NICKEL	\$1,437.00
<input type="checkbox"/>	121XA11	Spare Li-ion Power Pack - LITHIUM	\$1,849.00

**Xtender Wheel Options**

<input type="checkbox"/>	121XA8	SPARE 22" Lite Spoke Pneu Alum	NC
<input type="checkbox"/>	121XA9	SPARE 22" Lite Spoke Pneu Plastic	\$133.00
<input type="checkbox"/>	121XA2	SPARE 24" Lite Spoke Pneu Alum	NC
<input type="checkbox"/>	121XA4	SPARE 24" Lite Spoke Pneu Plastic	\$133.00

**Rear Wheels**

N/A w/ Xtender & 5 Spoke Mag Wheels. N/A w/ Hub Lock. Std Mag Wheels only available with One Arm Drive. 24" wheels. N/A with 8" and 9" frame depths. 8"-12" Frame Depth with 20-24" Rear Wheels and ELRs is ONLY available with Hub Lock Wheels.

<input type="checkbox"/>	121RW48	12" Mag (Not available with handrims or one arm drive)	\$43.00
<input type="checkbox"/>	121RW14	16" Mag (Not available with handrims or one arm drive)	NC
<input type="checkbox"/>	121RW3	20" Mag Wheel	NC
<input type="checkbox"/>	121RW8	22" Mag Wheel	NC
<input type="checkbox"/>	121RW1	24" Mag Wheel	NC
<input type="checkbox"/>	121RW103	20" Mag Wheel 5 Spoke	NC
<input type="checkbox"/>	121RW104	22" Mag Wheel 5 Spoke	NC
<input type="checkbox"/>	121RW102	24" Mag Wheel 5 Spoke	NC
<input type="checkbox"/>	121RW74	20" Lite Spoke Wheel	NC
<input type="checkbox"/>	121RW75	22" Lite Spoke Wheel	NC
<input type="checkbox"/>	121RW76	24" Lite Spoke Wheel	NC
<input type="checkbox"/>	121RW06	22" Ultra light wt. Spoke Wheel 2.0	\$329.00
<input type="checkbox"/>	121RW10	24" Ultra light wt. Spoke Wheel 2.0	\$329.00
<input type="checkbox"/>	121RW28	22" Spinergy SPOX Black Spokes	\$797.00
<input type="checkbox"/>	121RW95	24" Spinergy SPOX Black Spokes	\$797.00
<input type="checkbox"/>	121RW32	22" Spinergy LX Black Spokes	\$1,025.00
<input type="checkbox"/>	121RW98	24" Spinergy LX Black Spokes	\$1,025.00

**Rear Wheel Tire**

<input type="checkbox"/>	121RT3	Full Poly Tire	NC
<input type="checkbox"/>	121RT6	High Pressure Clincher	\$96.00
<input type="checkbox"/>	121RT27	Knobby V-TRAK by Kenda	\$111.00
<input type="checkbox"/>	121RT38	SHOX Performance Poly	\$134.00
<input type="checkbox"/>	121RT1	Pneumatic	NC
<input type="checkbox"/>	121RT2	Pneumatic Airless Insert	\$228.00
<input type="checkbox"/>	121RT21	Schwalbe Marathon Plus Evolution	\$145.00
<input type="checkbox"/>	121RT28	Schwalbe Speed	\$150.00
<input type="checkbox"/>	121RT4	Low Poly	NC

Tire	Wheel	5 Spoke Mag	Std. Mag	Lite Spoke	Ultra Light-weight	Spinergy
Full Poly Tire		20",22",24"	20",22",24"	20",22",24"		
High Pressure Clincher				22",24"	24"	22",24"
SHOX Performance Poly		20",22",24"		20",22",24"		22",24"
Knobby V-TRAK				24"		24"
Pneumatic		20",22",24"	12",16",20",22",24"	20",22",24"		22",24"
Pneumatic Airless Insert		20",22",24"	12",16",20",22",24"	20",22",24"		22",24"
Schwalbe Marathon Plus				24"	22",24"	22",24"
Schwalbe Speed Run				24"	24"	22",24"
Low Poly			12"	24"		

22" = 489 mm    24" = 540 mm

**Handrim**

N/A w/ Xtender. Natural Fit N/A w/ 20" and 22" 5 Spoke Mag Wheel

<input type="checkbox"/>	121HR1	Aluminum Anodized	NC
<input type="checkbox"/>	121HR4	Plastic Coated (N/A on Ultra and 22" Spinergy LX,SPOX)	\$134.00
<input type="checkbox"/>	121HR22	Natural Fit -Standard Grip (N/A on Ultra Lite or 20" Lite Spoke)	\$345.00
<input type="checkbox"/>	121HR23	Natural Fit - Super Grip (N/A on Ultra Lite or 20" Lite Spoke)	\$401.00
<input type="checkbox"/>	121HR30	Natural Fit LT - Standard Grip (N/A on Ultra Lite or 20" Lite Spoke)	\$480.00
<input type="checkbox"/>	121HR31	Natural Fit LT - Super Grip (N/A on Ultra Lite or 20" Lite Spoke)	\$546.00
<input type="checkbox"/>	121HR24	Spinergy Flex Rim (Only on 24" Spinergy LX)	\$647.00
<input type="checkbox"/>	121HR7	Omit Handrim (Option may not be available on all rear wheels)	(\$12.00)

**Axle Plate**

<input type="checkbox"/>	121AL33	Standard	NC
--------------------------	---------	----------	----

**4. REAR WHEELS/SEAT HEIGHT Cont.**

**One Arm Drive**

NA w/ Xtender. N/A w/ 12"-16" wheels. Only avail. On 12"-16" widths and 20", 22" and 24" mag wheels. N/A with Natural Fit handrims. N/A with SPHA arms

<input type="checkbox"/>	121AL16	One Arm Drive	\$1,276.00
<input type="checkbox"/>	121OA2	<b>Standard Handrim</b>	NC
<input type="checkbox"/>	121HM1	<input type="checkbox"/> Right Hand Mount	NC
<input type="checkbox"/>	121HM2	<input type="checkbox"/> Left Hand Mount	NC
<input type="checkbox"/>	121OA1	<b>Small Handrim</b> (N/A w/ 20" rear wheels)	NC
<input type="checkbox"/>	121HM1	<input type="checkbox"/> Right Hand Mount	NC
<input type="checkbox"/>	121HM2	<input type="checkbox"/> Left Hand Mount	NC

**Axle**

<input type="checkbox"/>	121AX1	Quick Release (N/A w/ One Arm Drive)	NC
<input type="checkbox"/>	121AX11	Quad Quick Release (Only Available with 12" and 16" Mag Wheels)	\$168.00

**Center of Gravity Preset** (dependent on wheels, casters & depth, From standard frame depth +2" forward and - depth growth up to -3")

<input type="checkbox"/>	121CC28	-0.5"	NC
<input type="checkbox"/>	121CC26	0 (Flush w/ backrest)	NC
<input type="checkbox"/>	121CC16	0.5" (Only avail 9"-18" deep)	NC
<input type="checkbox"/>	121CC20	1" (Only avail 10"-18" deep)	NC
<input type="checkbox"/>	121CC15	1.5" (Only avail 10"-18" deep)	NC
<input type="checkbox"/>	121CC17	2" (Only avail 16"-18" deep)	NC
<input type="checkbox"/>	121CC18	2.5" (Only avail 16"-18" deep)	NC

**Camber**

<input type="checkbox"/>	121C1	0°	NC
<input type="checkbox"/>	121C12	3° (N/A w/ Single Post Ht. Adj. Arm)	NC

**Rear Seat Height (see Allowable Squeeze chart)**

<input type="checkbox"/>	121RH32	11"	NC
<input type="checkbox"/>	121RH33	11.5"	NC
<input type="checkbox"/>	121RH9	12"	NC
<input type="checkbox"/>	121RH10	12.5"	NC
<input type="checkbox"/>	121RH11	13"	NC
<input type="checkbox"/>	121RH12	13.5"	NC
<input type="checkbox"/>	121RH13	14"	NC
<input type="checkbox"/>	121RH14	14.5"	NC
<input type="checkbox"/>	121RH15	15"	NC
<input type="checkbox"/>	121RH16	15.5"	NC
<input type="checkbox"/>	121RH17	16"	NC
<input type="checkbox"/>	121RH18	16.5"	NC
<input type="checkbox"/>	121RH19	17"	NC
<input type="checkbox"/>	121RH26	17.5"	NC
<input type="checkbox"/>	121RH20	18"	NC

Rear Wheel	Rear Seat Height														
	11"	11.5"	12"	12.5"	13"	13.5"	14"	14.5"	15"	15.5"	16"	16.5"	17"	17.5"	18"
12" low poly															
12" pneu															
16"															
20"															
22"															
24"															
24" pneu															

When tires are not listed default to the wheel size. All Heights are subject to vary slightly

**Allowable Squeeze (may vary +/- 1/2")**

Frame Depth	Max Squeeze
8"-9"	1.0"
10"-12"	1.5"
13"-15"	2.0"
16"-18"	2.5"

**5. WHEEL LOCK**

**Hub Lock**

Only available with 12" or 16" mag wheels or Lite Spoke wheels. Not available with One Arm Drive.

<input type="checkbox"/>	121LK01	12" Hub Lock	\$150.00
<input type="checkbox"/>	121LK02	16" Hub Lock	\$150.00
<input type="checkbox"/>	121LK04	20"-24" Hub Lock Lite Spoke	\$150.00

**Hub Lock Mount Position**

Foot lock may limit folding width.

<input type="checkbox"/>	121HH01	Foot lock Mount	NC
<input type="checkbox"/>	121HH02	Seat Mount	NC
<input type="checkbox"/>	121HH03	Back Mount (back ht. may be limited)	NC

**Wheel Lock**

N/A with Hub Lock. High Mount will be mounted in low position on 12 and 16 rear wheels. Some may not be available depending on wheel size and position.

<input type="checkbox"/>	121WL1	High Mount Push	NC
<input type="checkbox"/>	121WL2	High Mount Pull	NC
<input type="checkbox"/>	121WL30	Compact	\$150.00
<input type="checkbox"/>	121WL10	Omit	NC

**Extension Handle** (Only avail w/ High Mount Wheel Locks)

<input type="checkbox"/>	121EH1	6" Pair	\$67.00
--------------------------	--------	---------	---------

**Swing Away 8"-12" Frame Depth**

**Wheel Lock go/no-go matrix**

Frame Depth	C.G.	20" wheel	22" wheel	24" wheel	Frame Depth	C.G.	20" wheel	22" wheel	24" wheel
8"	-0.5"				11	-0.5"			
	0"					0"			
	0.5"					0.5"			
	1"					1"			
9"	-0.5"				12	1.5"			
	0"					-0.5"			
	0.5"					0"			
	1"					0.5"			
10"	-0.5"					1"			
	0"					1.5"			
	0.5"					No-go. User must use hublock.			
	1"					Go			
	1.5"								

**6. HANGER AND FOOTREST**

**Z-finity Hangers/Footrest System**

*N/A on Fixed Frame.*

*Some interference may exist in certain configurations.*

<input type="checkbox"/>	121H162	Z-finity Hanger	STD
<input type="checkbox"/>	121H160	Elevating Hanger - Ext Mount <i>Includes ELR pad. N/A w/ Z-finity. Some limitations may exist.</i>	\$313.00
<input type="checkbox"/>	121H144	Omit Hanger	NC

**Z-finity Footrest Mount (Must Choose see Illustration)**

<input type="checkbox"/>	121DI22	Direct Hanger Mt/Fixed Frame - High	NC
<input type="checkbox"/>	121DI23	Direct Hanger Mt/Fixed Frame - Low	NC
<input type="checkbox"/>	121DI24	Extension Tube Mount	NC

**Z-finity Footrest Pivot Arm (Must Choose, use matrix for leg length)**

<input type="checkbox"/>	121DI20	Short 2"	NC
<input type="checkbox"/>	121DI21	Long 3-1/4"	NC

**Footplate**

*Some interference may exist in certain configurations.*

<input type="checkbox"/>	121F320	Multi-Angle Adjustable - Pair <i>(N/A w/ 8"-9" widths)</i>	\$228.00
<input type="checkbox"/>	121F321	Angle Adjustable Platform Footboard	\$213.00
<input type="checkbox"/>	121F6	Omit Footplate	NC

**Extension Tube Length (When Choosing Ext. Tube Mount)**

<input type="checkbox"/>	121E62	Hemi	NC
<input type="checkbox"/>	121E1	Short	NC
<input type="checkbox"/>	121E2	Medium	NC
<input type="checkbox"/>	121E5	Long	NC

**Hanger Mounted Footrest (Footplates Mount to Hanger Tubing)**

*N/A with 8" and 9" width. Footplate mounted in lowest position may cause interference w/ caster.*

<input type="checkbox"/>	121H157	80° Swing In/Out Front Mount	NC
<input type="checkbox"/>	121H158	90° Swing In/Out Front Mount	NC

**Extensions (may interfere with some seat heights & casters)**

<input type="checkbox"/>	121E23	2" (not mounted)	\$49.00
<input type="checkbox"/>	121E24	4" (not mounted)	\$49.00

**Footplate**

<input type="checkbox"/>	121F9	K0040 Kids Angle Adjustable <i>(only available w/ 10"-16" frame widths)</i>	NC
<input type="checkbox"/>	121F8	K0040 Adult Angle Adj. <i>(only available with 10"-16" widths)</i>	\$162.00

**Swing In/Out Hanger Leg Lengths**

*(Seat sling to footrest measured)*

80° Hanger	Min	Max
No Ext. Tube	5.7"	9.7"
2" Ext. Tube	11.2"	12.2"
4" Ext. Tube	11.2"	14.1"
90° Hanger	Min	Max
No Ext. Tube	6.0"	10.0"
2" Ext. Tube	11.5"	12.5"
4" Ext. Tube	11.5"	14.5"

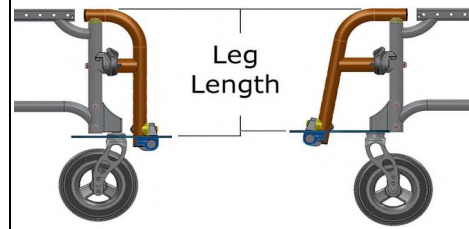

**Z-finity Matrix**

**Direct Hanger Mount**

**Extension Tube Mount**

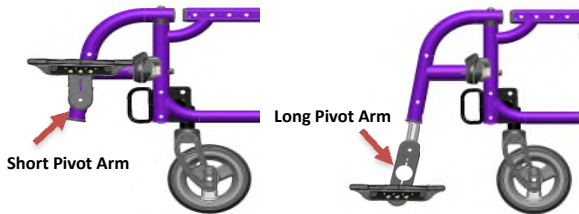

**Direct Hanger Mounted**

Pivot Arm	Hanger Mounting Position	Min	Max
Short	High Mount	0.5"	4.5"
	Low Mount	3.5"	8.0"
Long	High Mount	-1.0"	5.5"
	Low Mount	2.5"	9.0"

**Extension Tube Mounted**

Pivot Arm	Extension Tube Length	Min	Max
Short	Hemi Short	5.8"	14.1"
	Short	6.5"	15.1"
	Medium	8.4"	17.0"
Long	Long	10.3"	19.0"
	Hemi Short	4.6"	15.3"
	Short	5.2"	16.3"
	Medium	7.2"	18.3"
	Long	9.2"	20.2"

**ELR Ext Mt.(MED Ext Tube)**

Pivot Arm	Min	Max
Short	7.0"	18.0"
Long	6.0"	19.0"

**Footrest Options**

<input type="checkbox"/>	121HL8	Leg Strap <i>(N/A w/ Adult Angle Adj. footplates)</i>	\$57.00
<input type="checkbox"/>	121HL11	Heel Loops <i>(N/A w/ Kids Angle Adj. Z-finity. N/A on widths below 14")</i>	NC
<input type="checkbox"/>	121IG2	Neoprene Impact Guards <i>(N/A with footrest in highest mounted position)</i>	\$57.00

**7. BACKRESTS**

**BACKREST**

<input type="checkbox"/> 121BT10	Standard Backrest (Angle adj./folding)	NC	<input type="checkbox"/> 121BT101	Dynamic Backrest (N/A w/ Fixed Back)	\$1,438.00
----------------------------------	--	----	-----------------------------------	--------------------------------------	------------

**BACK TYPE (Choose Height Adjustable or Fixed Height)**

<input type="checkbox"/> 121BT120	Height Adjustable (see matrix below)	NC	<input type="checkbox"/> 121BT53	Fixed Height	NC
-----------------------------------	--------------------------------------	----	----------------------------------	--------------	----

**Height Adjustable (See Backrest Height Range matrix)**

Must choose Lower Base Tube, Backrest Style, and Upper Back Tube.

**Lower Base Tube (See Backrest Height Matrix Below)**

<input type="checkbox"/> 121BP58	Short	NC
<input type="checkbox"/> 121BP59	Medium	NC
<input type="checkbox"/> 121BP60	Tall (N/A with Dynamic Backrest)	NC

**Backrest Styles (See Images Below)**

<input type="checkbox"/> 121PH16	Straight Non Push Handle	NC
<input type="checkbox"/> 121PH6	Integral Push handle	NC
<input type="checkbox"/> 121PH17	Folding Push Handle with Ht. Adj. Back (8"-10" widths, stroller handle will face outward)	\$286.00
<input type="checkbox"/> 121PH15	Omit Back Tube (See omit matrix)	NC

**Upper Back Tube (See Backrest Height Matrix Below)**

<input type="checkbox"/> 121B245	Short	NC
<input type="checkbox"/> 121B5	Medium	NC

**Height Adjustable Backrest**

Preset Back height (Choose for Set Up)  
No Upholstery w/ 19"-24"

<input type="checkbox"/>	9"	<input type="checkbox"/>	15"	<input type="checkbox"/>	20"
<input type="checkbox"/>	11"	<input type="checkbox"/>	16"	<input type="checkbox"/>	21"
<input type="checkbox"/>	12"	<input type="checkbox"/>	17"	<input type="checkbox"/>	22"
<input type="checkbox"/>	13"	<input type="checkbox"/>	18"	<input type="checkbox"/>	23"
<input type="checkbox"/>	14"	<input type="checkbox"/>	19"	<input type="checkbox"/>	24"

**Fixed Height**

Fixed Height back N/A with upholstery

<input type="checkbox"/> 121BP9	Standard (16" Height)	NC
<input type="checkbox"/> 121BP10	Medium (20" Height)	NC
<input type="checkbox"/> 121BP11	Tall (23" Height)	NC
<input type="checkbox"/> 121BP61	Standard w/ Folding PH (16" Height)	\$286.00
<input type="checkbox"/> 121BP62	Medium w/ Folding PH (20" Height)	\$286.00
<input type="checkbox"/> 121BP63	Tall w/ Folding PH (23" Height)	\$286.00

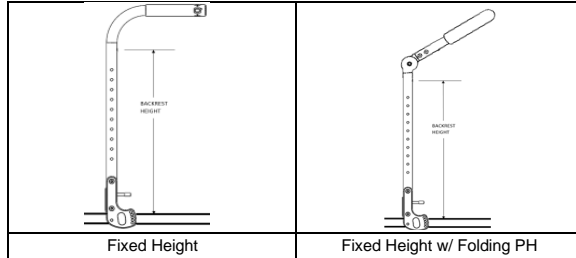

**Backrest Height Ranges**

**Upper Back Tube (Choose One)**

			Straight non-push handle Short	Straight non-push handle Medium	Integral push handle Short	Integral push handle Medium	Folding Push Handle Short	Folding Push Handle Medium	Omit
Lower Base Tube (Choose one)	Standard	Short	11"-15"	15"-19"	11"-15"	15"-19"	12"-16"	16"-20"	9"
		Medium	15"-19"	18"-23"	15"-19"	18"-23"	16"-20"	19"-24"	13"
		Tall	18"-22"	18"-24"	18"-22"	18"-24"	19"-23"	19"-24"	16"
	Dynamic	Short	14"-18"	18"-22"	14"-18"	18"-22"	15"-19"	19"-23"	12"
		Medium	18"-22"	21"-24"	18"-22"	21"-24"	19"-23"	22"-24"	16"

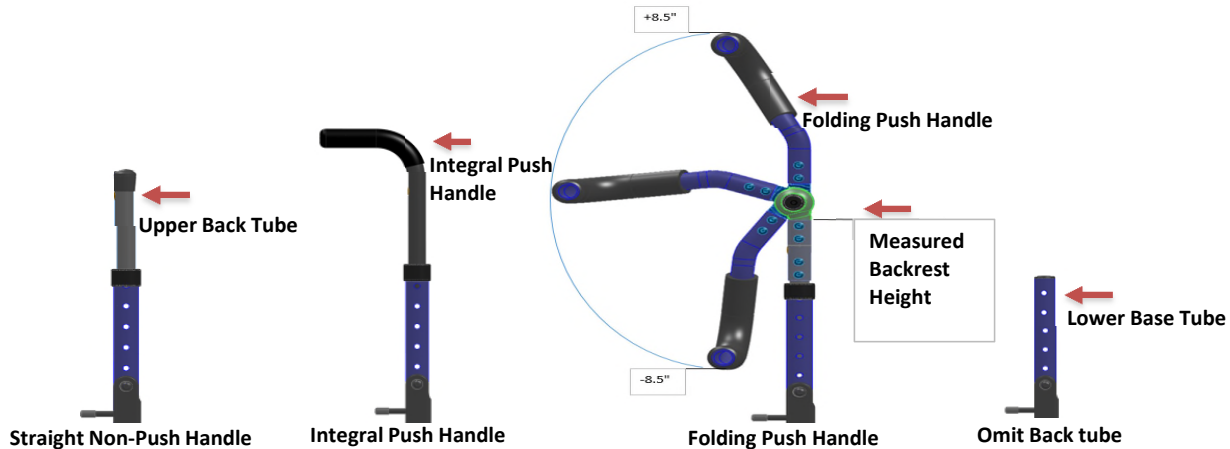

**7. BACKRESTS Cont.**

**Back Upholstery**

Uph N/A with Fixed Height back. Std Uph N/A w/Flip-Up, Adj. Locking Flip-Up and Length Adj Locking Flip-up . 3DX N/A on 8"-11" widths. Ballistic N/A on 8"-9" widths.

<input type="checkbox"/>	121BU1	Standard Upholstery	STD
<input type="checkbox"/>	121BU71	Backrest Tension Adj. 3DX Vented	\$435.00
<input type="checkbox"/>	121BU70	Backrest Tension Adj. Ballistic	\$390.00
<input type="checkbox"/>	121BU66	Omit Back Upholstery	(\$21.00)

**JAY Back (Optional)**

To order any other JAY back on-chair, please See the JAY Price List. Requires Part #

<input type="checkbox"/>	121JB02	JAY Bundled Backrest	Price List
		Backrest Name or Part #	
		Width (in.):                      Height (in.):	

**Stabilizer Bar**

N/A w/ Dynamic back and Fixed Back. Only available w/ Integral push handle.

<input type="checkbox"/>	121SZ1	Stabilizer Bar	\$156.00
--------------------------	--------	----------------	----------

**8. ARMRESTS/SIDEGUARDS**

**Armrest and Armpad - Height Adjustable**

Flip-Up, Adj. Locking Flip-Up and Length Adj. Locking Flip-up N/A with Std Back Upholstery. Low RSH in combination with large wheels may result in arm interference. SPHA arms N/A with One Arm Drive or Xtender.

<input type="checkbox"/>	121AA58	T-Post Xtra Tall(with sideguard)	\$256.00
<input type="checkbox"/>	121AA59	T-Post 2X Tall(with sideguard)	\$256.00
<input type="checkbox"/>	121AA3	Flip-Up	NC
<input type="checkbox"/>	121AA1	Adjustable Locking Flip-Up	\$313.00
<input type="checkbox"/>	121AA7	Length Adjust. Locking Flip-Up	\$313.00
<input type="checkbox"/>	121AA11	Single-Post Ht Adj. Std. (N/A w/ 3° camber or 8"-9" frame depths)	\$313.00
<input type="checkbox"/>	121AA29	Single-Post Height Adj. Low (N/A w/ 3° camber or 8"-9" frame depths)	\$313.00
<input type="checkbox"/>	121AA14	Omit Armrest	NC

**Side Guard**

N/A with height adjustable armrests and T-Posts

<input type="checkbox"/>	121SG33	Plastic Std	\$173.00
<input type="checkbox"/>	121SG29	Plastic Low	\$173.00

**Armpad**

N/A with T-Post and Adj. Locking Flip-Up and Foam only available with Length Adj. Locking Flip-Up.

<input type="checkbox"/>	121AM23	Desk Classic	NC
<input type="checkbox"/>	121AM24	Full Classic (N/A w/ 10"-13" Depth)	NC
<input type="checkbox"/>	121AM9	Foam Short (N/A w/ T Post)	NC
<input type="checkbox"/>	121AM10	Foam Long (N/A w/ T Post)	NC

**Single Post Height Adjustable Armrest**

Pad	Armrest Size	Transfer Tube Length (D)	Range (H)	Pad Length (L)	
				Desk	Full
Classic	STD	8"	9-1/2" to 14-1/2"	10-1/4"	14"
	LOW	5-1/4"	8" to 12"		

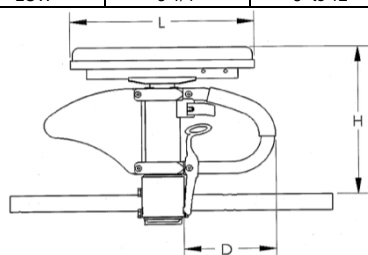

Armrest Size	T-POST	
	Range (H)	Pad Length (L)
XTALL	6" to 7"	7"
2X TALL	7-1/2" to 8-1/2"	

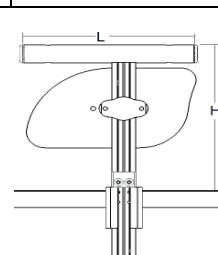

**9. ACCESSORIES**

Backpack (one Backpack Black/Charcoal already included)			
<input type="checkbox"/>	121A1	Black Utility Backpack	\$103.00
<input type="checkbox"/>	121A2	Backpack Black/Charcoal Kids	\$96.00

Miscellaneous			
<input type="checkbox"/>	1218A03	Caddy (Only avail w/ Ext. Mt. hangers)	\$83.00
<input type="checkbox"/>	1213A01	Tool Kit	\$39.00
<input type="checkbox"/>	121A2100	Crutch Holder	\$106.00

Positioning Belt			
<input type="checkbox"/>	121A823	Belt 1" Dual Adj. Sqz Blk Pad	\$96.00
<input type="checkbox"/>	121A824	Belt 2" Aircraft Buckle	\$129.00
<input type="checkbox"/>	121A825	Belt 2" Aircraft Buckle Padded	\$188.00
<input type="checkbox"/>	121A826	Belt 1.5" Auto Buckle	\$83.00
<input type="checkbox"/>	121A814	1" Comfort Fit APB5116	\$134.00

Upper Extremity Support Tray			
<i>N/A with 8"-9" widths</i>			
<input type="checkbox"/>	121A29	X-Small (Suggested 10"-12" chair width)	\$351.00
<input type="checkbox"/>	121A30	Small (Suggested 13"-14" chair width)	\$351.00
<input type="checkbox"/>	121A31	Medium (Suggested 15"-17" chair width)	\$351.00
<input type="checkbox"/>	121A32	Large (Suggested 18"-20" chair width)	\$351.00

Seat Pouch			
<input type="checkbox"/>	1211A01	Black	\$77.00

Anti-Tip			
<input type="checkbox"/>	121AT1	Rear Anti-Tip	\$111.00
<input type="checkbox"/>	121AO1	Front Anti-Tip (N/A with transit opt.)	\$145.00

Spoke Guard			
<i>N/A with 12" and 16" rear wheels or 5 spoke mag or Xtender</i>			
<input type="checkbox"/>	1214A01	Black	\$145.00
<input type="checkbox"/>	1214A02	Clear Zippie	\$145.00

Designer Spoke Guard			
<i>Only available with 22" or 24" Spoke rear wheels</i>			
<input type="checkbox"/>	1214A10	Basketball	\$185.00
<input type="checkbox"/>	1214A11	Chrome Wheels	\$185.00
<input type="checkbox"/>	1214A12	Graffiti	\$185.00
<input type="checkbox"/>	1214A13	Happy Lions	\$185.00
<input type="checkbox"/>	1214A14	Hot Wheels	\$185.00
<input type="checkbox"/>	1214A15	Mice n Cheese	\$185.00
<input type="checkbox"/>	1214A16	Princess	\$185.00
<input type="checkbox"/>	1214A17	Space Galactica	\$185.00
<input type="checkbox"/>	1214A18	Super Hero	\$185.00
<input type="checkbox"/>	1214A19	Zebra	\$185.00

**10. COLOR (Standard with frame and cross brace color choices)**

Frame Color (Must choose)			
Standard Colors			
<input type="checkbox"/>	121C140	Aztec Gold	NC
<input type="checkbox"/>	121C2	Black (N/A as base w/Zebra)	NC
<input type="checkbox"/>	121C141	Black Cherry	NC
<input type="checkbox"/>	121C10	Black Opal	NC
<input type="checkbox"/>	121C38	Blue Opal	NC
<input type="checkbox"/>	121C36	Candy Blue	NC
<input type="checkbox"/>	121C14	Candy Purple	NC
<input type="checkbox"/>	121C35	Candy Red	NC
<input type="checkbox"/>	121C142	Electric Blue	NC
<input type="checkbox"/>	121C143	Evergreen	NC
<input type="checkbox"/>	121C126	Glow	NC
<input type="checkbox"/>	121C144	Green Apple	NC
<input type="checkbox"/>	121C147	Hot Sparkle Pink	NC
<input type="checkbox"/>	121C148	Mauve Pink	NC
<input type="checkbox"/>	121C103	Rootbeer	NC
<input type="checkbox"/>	121C114	Sparkle Silver	NC
<input type="checkbox"/>	121C145	Sunrise Orange	NC
<input type="checkbox"/>	121C113	Titanium Color Paint	NC
<input type="checkbox"/>	121C8	Yellow	NC

Standard Matte Colors			
<input type="checkbox"/>	121C116	Matte Black	NC
<input type="checkbox"/>	121C151	Matte Black Cherry	NC
<input type="checkbox"/>	121C152	Matte Purple	NC
<input type="checkbox"/>	121C150	Matte Electric Blue	NC
<input type="checkbox"/>	121C149	Matte Evergreen	NC

Custom Colors (Must choose cross brace std. color)			
<input type="checkbox"/>	121C43	Mossy Oak Camouflage	\$340.00
<input type="checkbox"/>	121C42	Stars and Stripes	\$340.00
<input type="checkbox"/>	121C108	Zebra (Choose base color above: White Std. N/A Black)	\$340.00

Cross Brace Color			
Standard Colors			
<input type="checkbox"/>	121C600	Aztec Gold - Cross Brace	NC
<input type="checkbox"/>	121C601	Black - Cross Brace	NC
<input type="checkbox"/>	121C602	Black Cherry - Cross Brace	NC
<input type="checkbox"/>	121C603	Black Opal - Cross Brace	NC
<input type="checkbox"/>	121C604	Blue Opal - Cross Brace	NC
<input type="checkbox"/>	121C605	Candy Blue - Cross Brace	NC
<input type="checkbox"/>	121C606	Candy Purple - Cross Brace	NC
<input type="checkbox"/>	121C607	Candy Red - Cross Brace	NC
<input type="checkbox"/>	121C608	Electric Blue - Cross Brace	NC
<input type="checkbox"/>	121C609	Evergreen - Cross Brace	NC
<input type="checkbox"/>	121C610	Glow - Cross Brace	NC
<input type="checkbox"/>	121C611	Green Apple - Cross Brace	NC
<input type="checkbox"/>	121C612	Hot Sparkle Pink - Cross Brace	NC
<input type="checkbox"/>	121C613	Mauve Pink - Cross Brace	NC
<input type="checkbox"/>	121C614	Rootbeer - Cross Brace	NC
<input type="checkbox"/>	121C615	Sparkle Silver - Cross Brace	NC
<input type="checkbox"/>	121C616	Sunrise Orange - Cross Brace	NC
<input type="checkbox"/>	121C617	Titanium Color Paint - Cross Brace	NC
<input type="checkbox"/>	121C618	Yellow - Cross Brace	NC

Standard Matte Colors			
<input type="checkbox"/>	121C619	Matte Black - Cross Brace	NC
<input type="checkbox"/>	121C620	Matte Black Cherry - Cross Brace	NC
<input type="checkbox"/>	121C621	Matte Purple - Cross Brace	NC
<input type="checkbox"/>	121C622	Matte Electric Blue - Cross Brace	NC
<input type="checkbox"/>	121C623	Matte Evergreen - Cross Brace	NC

Additional Options Through Built-4-Me			
<i>To inquire about any unique customization for Quickie products, contact: U@) ^H@00) 263-3390, Fax: (800) 561-5834</i>			
<b>Commonly Requested Options Include:</b>			
<input checked="" type="checkbox"/>	Solid Seat		
<input checked="" type="checkbox"/>	Grade Aid		
<input checked="" type="checkbox"/>	Drum Brake		

